

TITLE : EXISTING BUILDING PLAN OF M.M. COLLEGE OF EDUCATION AT SURVEY NO. 70, ANUBHAVA MANTAPA, DAVANAGERE,(DI) KARNATAKA.
 Run by Sri, TARALABALU JAGADGURU EDUCATION SOCIETY,(Reg) SIRIGERE.

SCALE: 1:100 & 1:100
 ALL DIMENSIONS ARE IN METRES ONLY



SCHEDULE OF OPENINGS	
1 RS	3.05 X 2.29
2 D	1.06 X 2.43
3 d	0.83 X 2.43
4 W	1.09 X 1.52
5 V	1.09 X 0.45

AREA STATEMENT	
SITE AREA AS PER DRAWING: 11132.89 SMT(2 acre 30 gunt)	
SITE AREA AS PER DOCUMENT: 11132.89 SMT(2 acre 30 gunt)	
BUILT-UP AREA IN SMT:	
BASEMENT FLOOR AREA:	148.27 SMT
GROUND FLOOR AREA:	878.94 SMT
FIRST FLOOR AREA:	775.92 SMT
SECOND FLOOR AREA:	775.92 SMT
TOTAL AREA:	2579.05 SMT
TOTAL BUILT-UP AREA:	2579.05 SMT

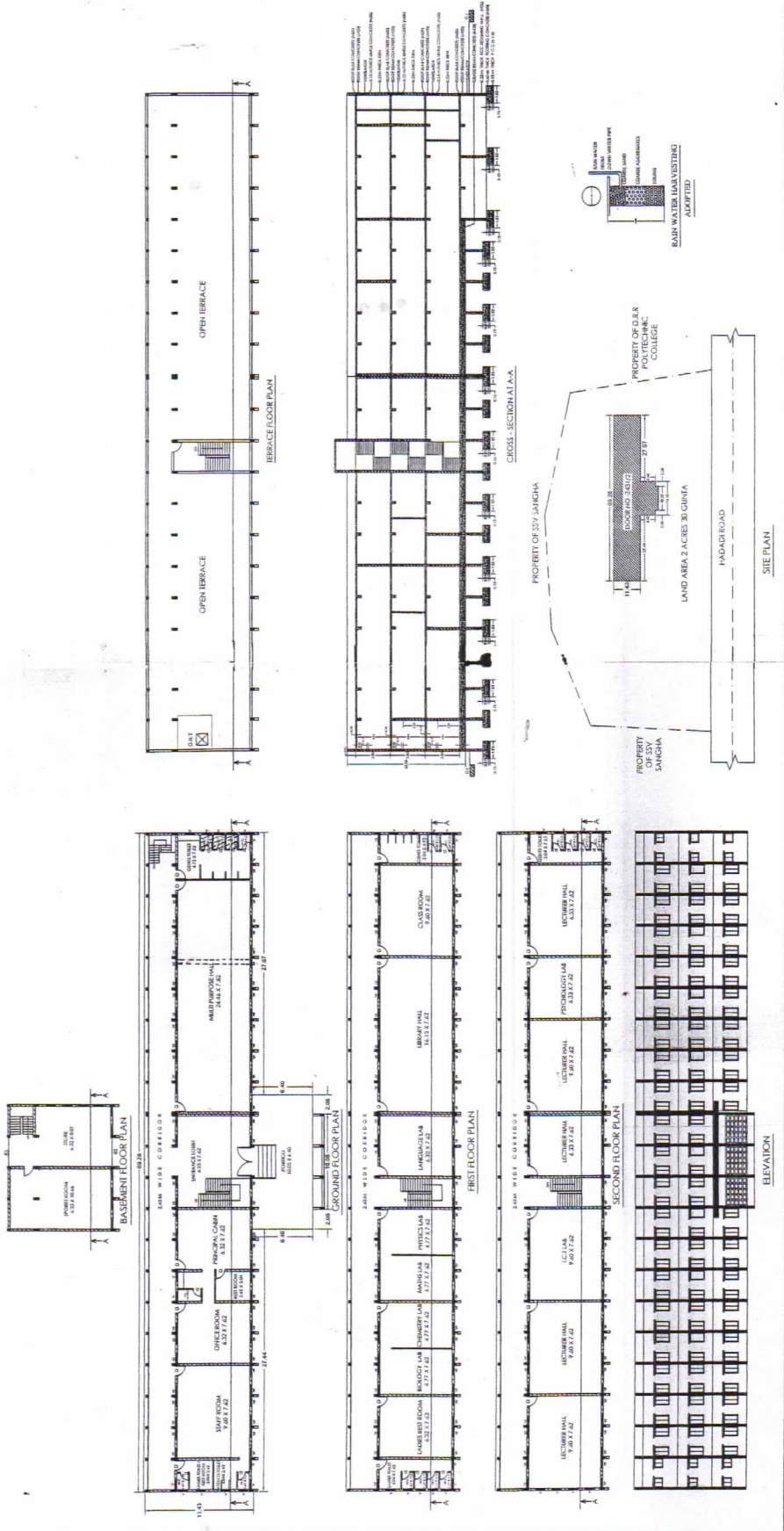

PROJECT APPLICANT:

Administrative Officer
 Sri Taralabalu Jagadguru
 Education Society, SIRIGERE-577541
 Chitradurga Dist.

STJ EDUCATION SOCIETY, SIRIGERE.

DOOR NO : 3431/2, MM COLLEGE OF EDUCATION.

ARCHITECTS & ENGINEERS:

H. S. Narayana
 R.E. (C.V.41)

DATE	REVISION	NO.	BY	DATE
28-07-2021				

Site inspected and found that Super Structure is constructed as per the above plan and all dimension are as per the plan.

(Signature)
 Assistant Engineer
 Davanagere District

M.M. College of Education
 Principal
 M.M. College of Education
 DAVANGERE - 577 004
 Karnataka State